

Displacement unit for floor assembly

- Fits raised floor systems with plates 600x600
- Available with plenum boxes
- Made in special sizes
- Easy to install

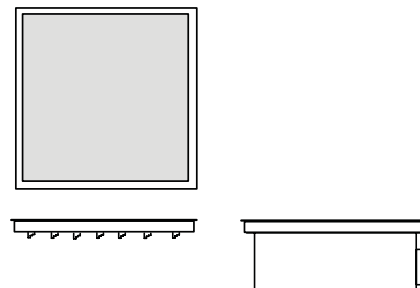

Function

EBO series terminals are installed in the floor to provide a displacement ventilation system. The terminals are recessed in a pressurized floor or duct connected by means of a plenum box in the floor.

Design

EBO has a rigid front which can stand a point load of 160 kg. The front consists of perforated sheet steel welded to a frame work. The height of the frame is adapted to fit the floor system. Common values are 30-40mm. In order to provide an even air distribution a plate with nozzles is installed behind the reinforced front. The front and air distribution plate is laying lose in the floor. EWB 06-06 is

a standard unit which replaces a floor plate 600x600 in raised floor systems. If preferable a plenum box can be supplied and installed in the raised floor to provide a duct connected system. EWB is also made in sizes according to costumers' specification.

Material

Front 3mm sheet steel
 Frame 2mm sheet steel
 Distribution plate and plenum boxes 0.7mm electro galvanized sheet steel. The front and frame is powder painted in RAL9011

Frontal face

EBO has a not perforated area of about 20mm on all sides. In some applications it is suitable to supply the air with a long and narrow terminal. The terminal is then divided into several lengths max 2m. In order to improve the visual impact the gable units has non perforated area of 22mm on 3 sides and in between units 22mm on 2 sides.

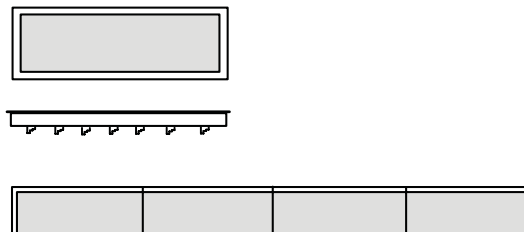

Accessories

Plenum boxes

Special versions

Other RAL colours
 EBO units can be supplied with the perforated front made in stainless steel EN 1.4301 surface brushed
 Plenum boxes with damper in spigot

Assembly

EBO 0606 replaces a floor plate in raised floor systems. The EBO is ordered and manufactured with a height (C) to fit to floor plates at site.

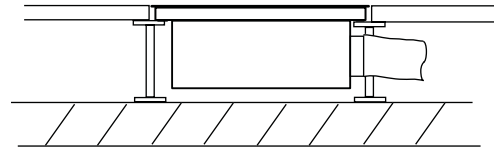
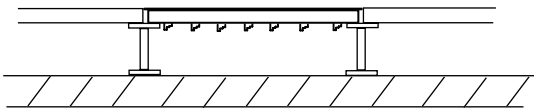

An air duct can also be made in the floor with single EBOs or a row of terminals. The front is laying on a support made in the floor construction. The support is done with a max width of 25 mm. The air velocity in the floor duct should for comfort applications not exceed 3 m/s. For accurate data contact your nearest sales representative.

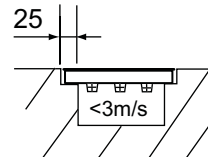

Dimensions

EBO 06-06

Plenum box 06-06

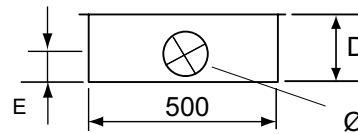
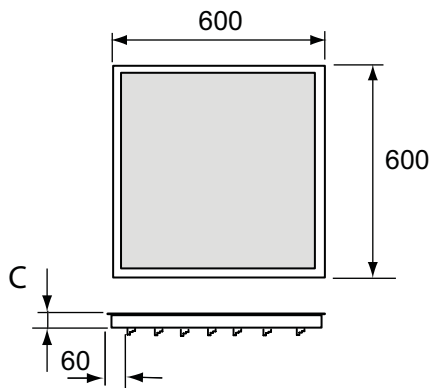

Ø	160	200
D	210	250
E	180	220

Special Sizes

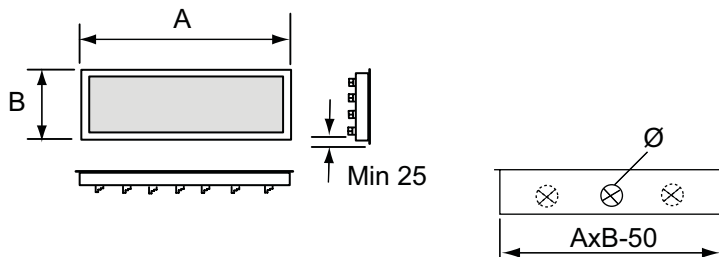

	Max	Min
A	2000	200
B	600	150
C	45	30

If necessary the plenum boxes can be supplied with two or more connections

Technical Data

EBO 0606

Sound power level (L_{WA}), total pressure drop (Δp_t) and adjacent zone ($L_{0,2}$) for under temperature (Δt_u) 3K and 6 K is shown in diagram .

EBO specials

In order to get accurate data use BEMAIRs selection program or contact your nearest sales representative. As a guideline for comfort applications a max air flow of 250 l/s,m2 over the gross front surface can be used.

Maintenance

Clean with water and mild detergent. The front is easy removable for internal cleaning.

Specification

BEMAIR EBO displacement unit for floor mounting.

Width Length

Height.(plate thickness)..... Reinforced front with 3mm perforated sheet steel. Front powder coated in RAL9011 matt or special colour according to RAL.

Accessory

Plenum box EBO width..... height.....

height..... connection \varnothing

Product code

EBO 06-06 / C

Plate thick-
ness

Plenum EBO 06-06/ \varnothing

Connection
160,200

