

# AWB

## Bow shaped displacement unit

- **Special dimensions**
- **Compact design**
- **High finish**
- **Suitable for all types of rooms**

AWB is a bow shaped displacement unit for wall mounting, which provides supply air at low velocity. The terminals are suitable for both comfort and industrial installations. AWB can be installed with optional base, decorative top and duct cover. Width, depth and circular spigot sizes are standardized, with the height to the customer's requirement.

### Design

The unit consists of a wall mounted back plate with top and bottom panels and an air distribution plate with nozzles. Top or bottom connections are available for circular or rectangular spigots. Rear connection with circular spigot is available if a duct cover is used. The perforated front panel is screwed on to the corners of the profiled back plate. The circular spigot is located on the top panel as standard, and can be fitted on the bottom panel upon request. If ordered without a duct cover, the terminal is delivered with a steel top lid, painted to suit the perforated front panel.

### Material

Front plate made in 1.25 mm hot dipped galvanized sheet steel. Other parts in galvanized sheet steel with thickness depending on size. Visible parts powder coated in RAL 9010. Other colors according to RAL or NCS are available on request.

### Specials versions

Other dimensions

Stainless steel    Standard EN 1.4301 Surface brushed  
 Other qualities on request

Reinforced front

### Accessory

- Duct cover
- Base
- Decorative top
- Damper

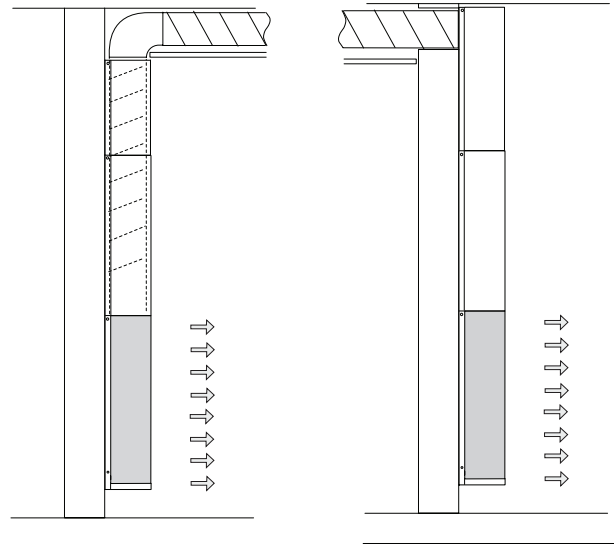
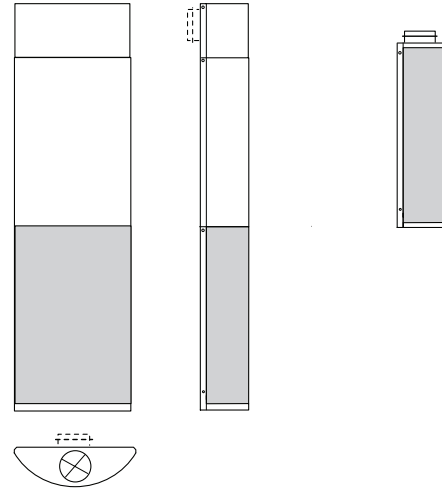

Round top connection and duct cover

Round rear connection in the duct cover.

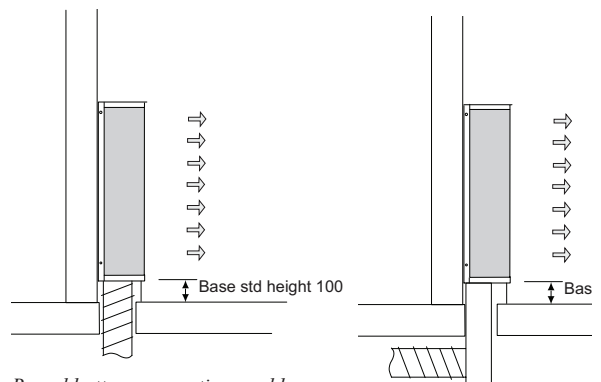

Round bottom connection and base.

Rectangular bottom connection and supply duct with round connection.

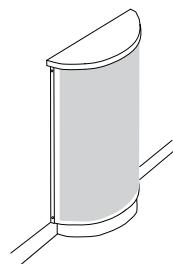

Unit with bottom connection, base and decorative top.

**Dimensions and weights recommended sizes**

A,C,Ø is standard dimensions.

B is chosen according to costumers requirement

Bs = recommended height B to suit A,C,Ø

Max B is 2000

**Table 1**

AWB-T/B	A	Bs	C	D	Ø	kg
100	400	600	150	70	100	25
125	500	600	180	83	125	30
160	640	600	210	100	160	38
200	800	1000	250	120	200	47

**Table 2**

AWB-R	A	Bs	C	Ø	kg
125	400	600	150	125	25
160	500	600	180	160	30
200	640	600	210	200	38
250	800	1000	250	250	47

**Table 3**

AWB/O-T/B	A	Bs	C	D	Ø	kg
100	400	600	150	70	100	8
125	500	600	180	83	125	9
160	640	600	210	100	160	10
200	800	1000	250	120	200	24

**Table 4**

AWB/O-TB	A	Bs	C	e	f	kg
001-600	400	600	150	60	280	90
002-600	500	600	180	60	350	10
003-600	640	600	210	90	400	11
004-1000	800	1000	250	100	600	25

**Accessory**

Base: Standard height of base is 100 , other heights on request.

Supply duct: Length is made according to request

**Table 5**

AWB/O	g	h	Ø	L
001	284	64	160	280-2000
002	354	64	160	280-2000
003	404	94	200	320-2000
004	604	104	250	370-2000

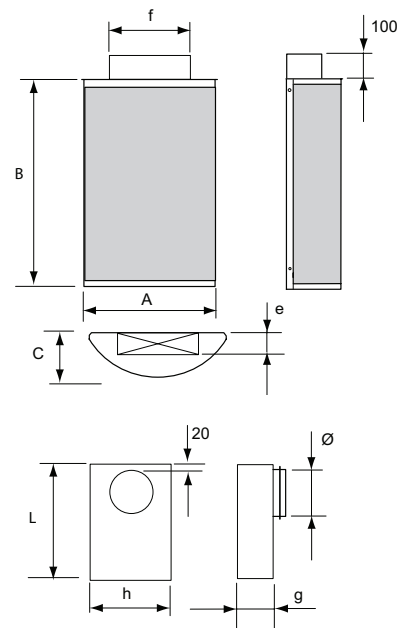
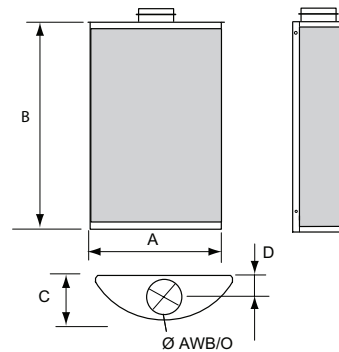
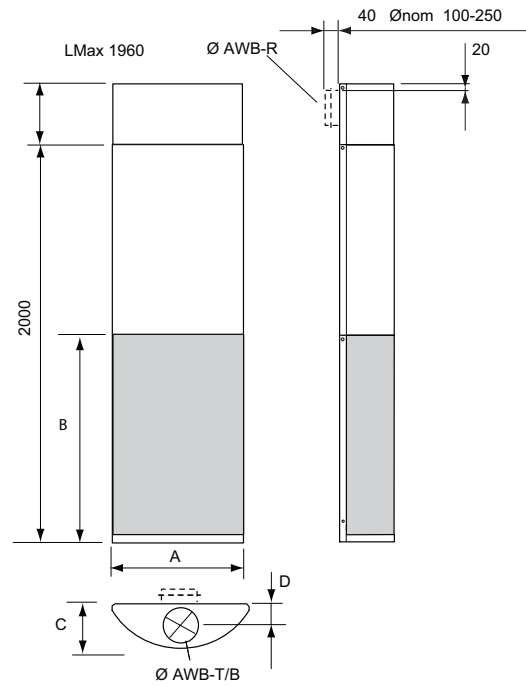

**Quick selection table AWB standard sizes**

dB(A) value as sound power level L<sub>w</sub>A

Adjacent zones L<sub>02</sub> for under temperute 3K and 6K

**AWB Round connection top or bottom as table 1 and table 3**

The velocity over the front is 0.15m/s

Size	l/s	dB(A)	L <sub>02</sub> m
100-600	35	38	0.5/0.8
125-600	50	36	0.6/1
160-600	63	31	0.7/1.1
200-1000	130	37	0.9/1.4

**AWB-R rear connection as table 2**

The velocity over the front is 0.2m/s

Size	l/s	dB(A)	L <sub>02</sub> m
125-600	50	36	0.7/1.1
160-600	68	34	0.9/1.3
200-200	85	32	0.9/1.4
250-1000	170	36	1.2/1.8

**AWB Rectangular connection top or bottom as table 4**

The velocity over the front is 0.2m/s

Size	l/s	dB(A)	L <sub>02</sub> m
001-600	50	33	0.7/1.1
002-600	68	35	0.9/1.3
003-600	85	31	1/1.5
004-1000	170	31	1/1.6

**Assembly**

The AWB terminal is wall mounted by removing the front plate and screwing the back plate in place. If a base is used, it is to be fitted first to the bottom of the terminal.

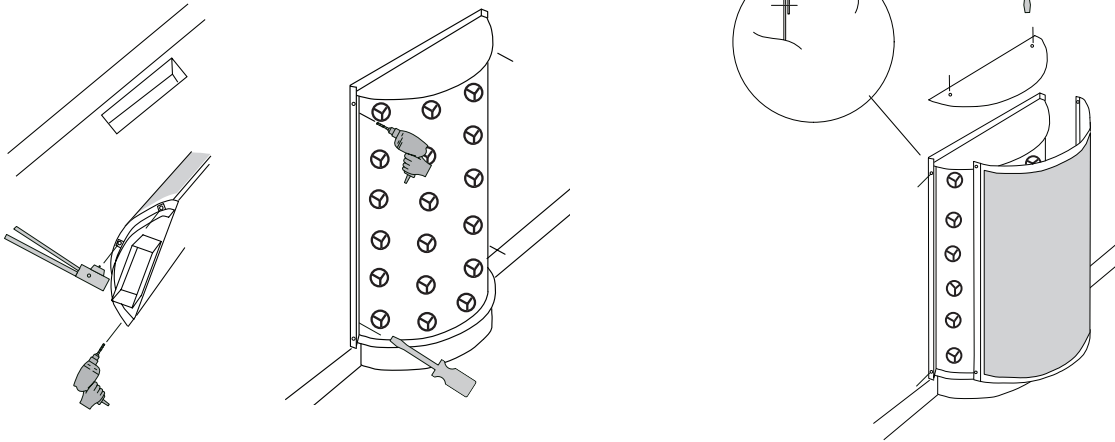

The duct cover is mounted to the wall using corner profiles. The length of the duct cover is made according to customer's specification. Maximum section length 1960mm. For longer ducts, several sections can be selected, taking care to overlap them on the join.

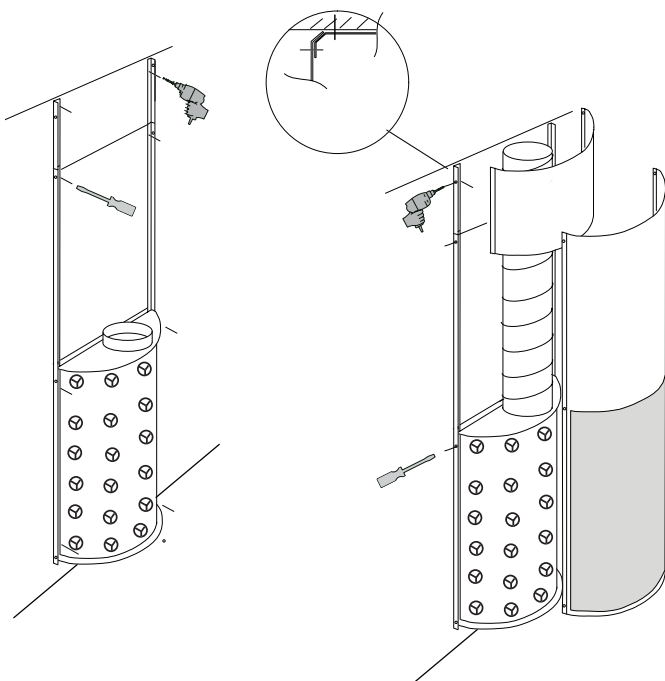
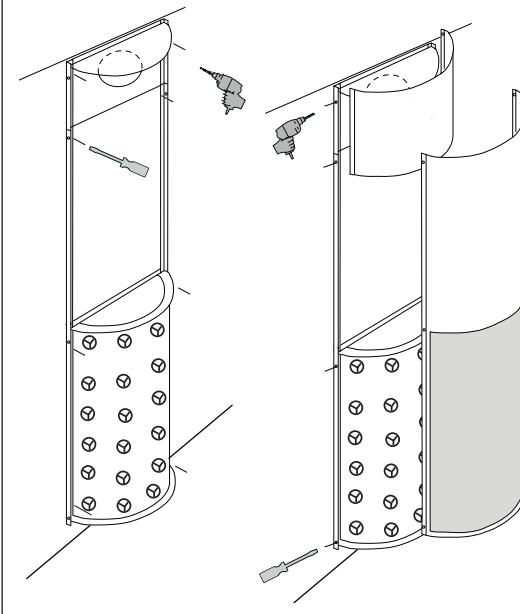
*Top connection*

*Rear connection*

**Maintenance**

There are no parts in the units that have to be replaced. If necessary clean the front with water and mild detergent.

**Specification**

BEMAIR AWB bow shaped displacement unit to be mounted on walls. Terminal including internal air distribution plate with nozzles. Width... mm Depth... mm Height...mm top/bottom/rear connection ..... mm. Removable front and corner profiles made in galvanized sheet steel powder coated in RAL 9010.

Alt. Top lid made in powder painted sheet steel/ Duct cover with corner profiles in galvanized sheet steel powder coated in RAL 9010. Duct covers length above terminal .....mm.

Accessory: Base with height 100mm in galvanized sheet steel powder coated in RAL 9010. Alt. Powder coat in special color according to RAL or NCS.

Supply duct in galvanized sheet steel t total length .....mm with round connection Ø ... mm.

Product code

AWB aaa-bbbb-c-ddd RAL9010

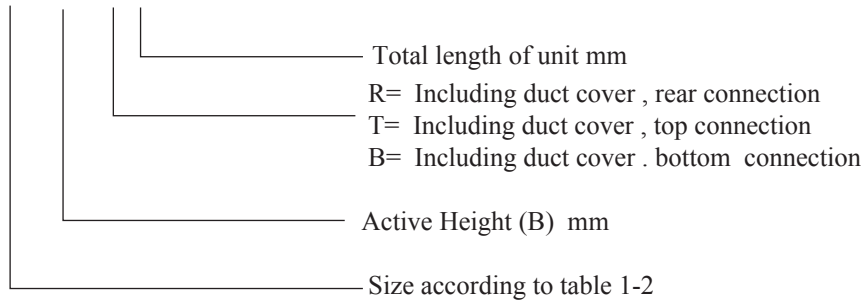

AWB/O aaa-bbbb-c RAL9010

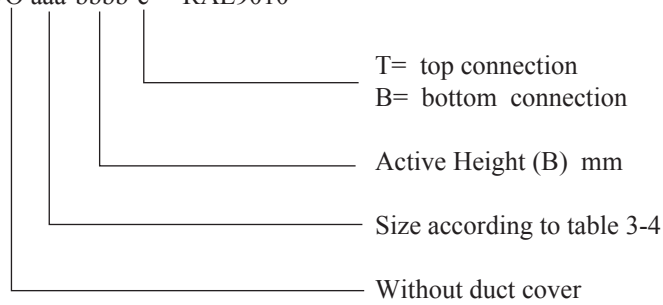

Base AWB-aaa-b /100 RAL9010

